

4

3

2

1

NOTES:

- 1. DENSITY TO BE A MIN OF 3.0 LBS/FT³.
- 2. MATERIAL TO BE A MIN 50 PSI COMPRESSIVE STRENGTH.
- 3. NO BURRS OR LOOSE MATERIAL LARGER THAN .10".
- 4. DRAWING IS FOR INSPECTION PURPOSES ONLY. ALL UNDIMENSIONED FEATURES TO BE HELD +/- .020" WITH RESPECT TO 3D CAD MODEL.

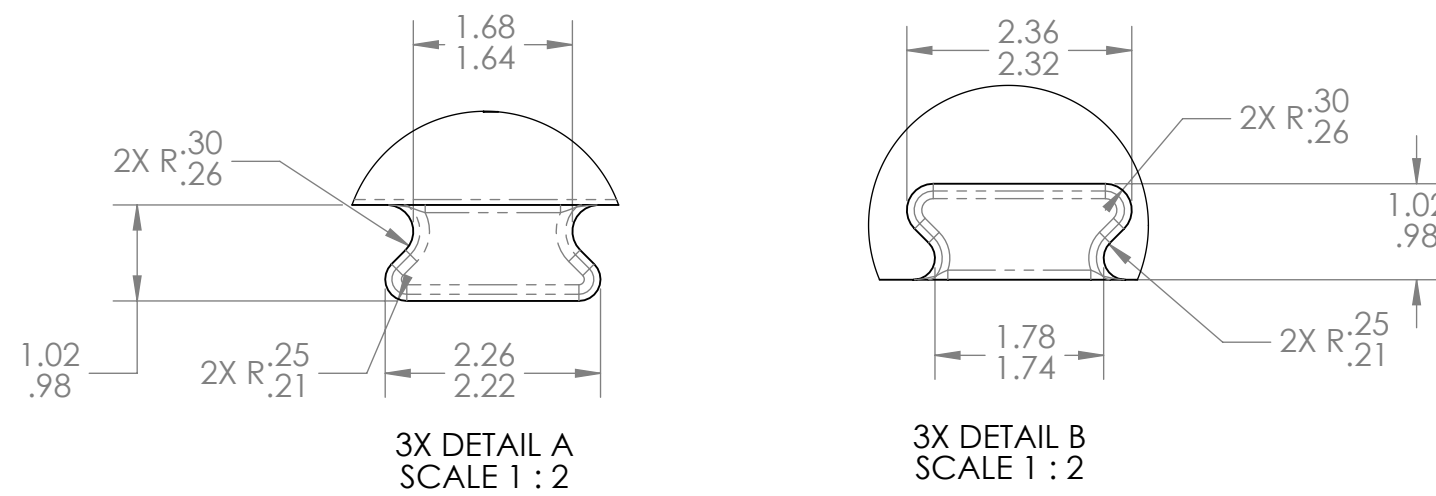
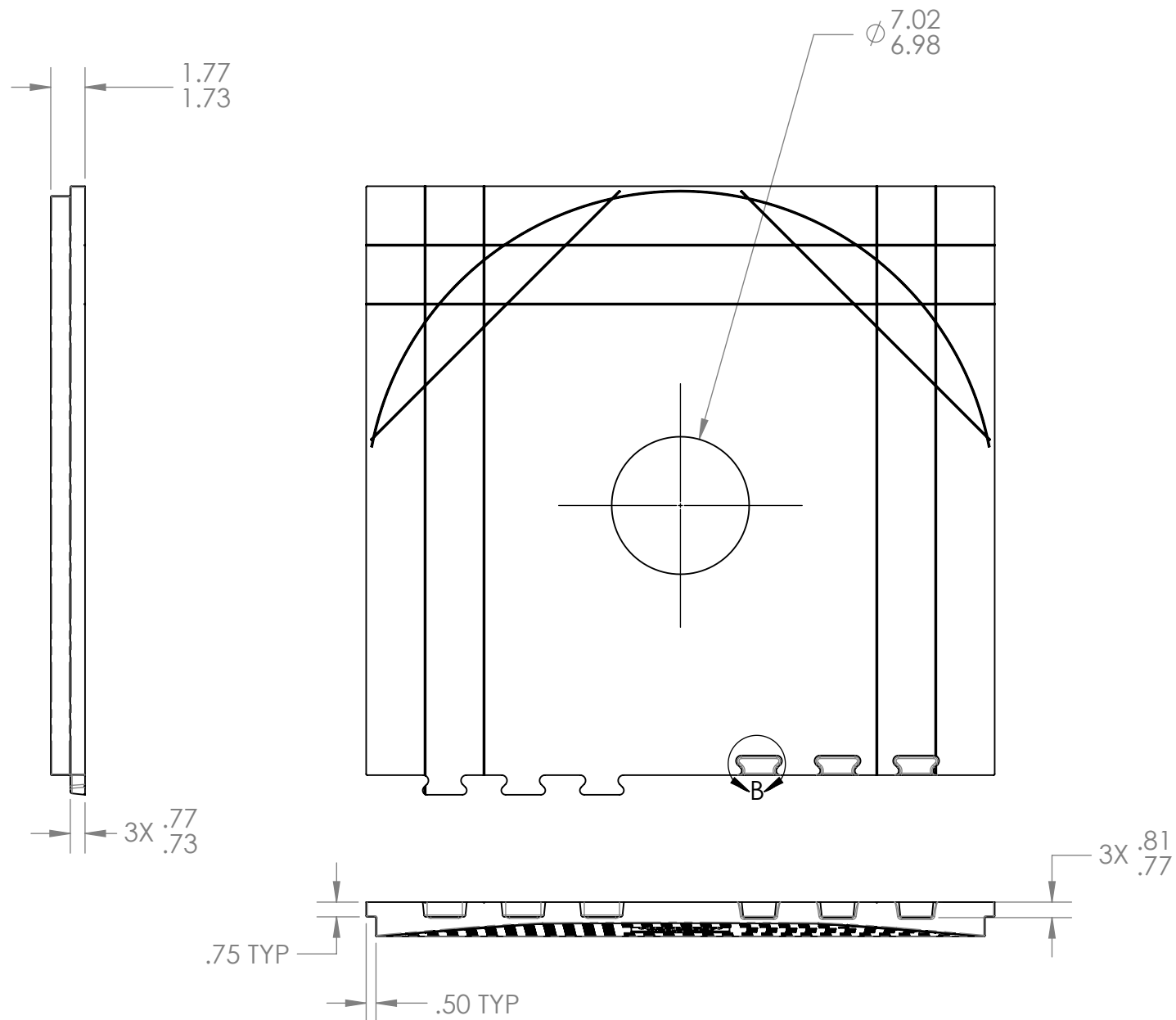
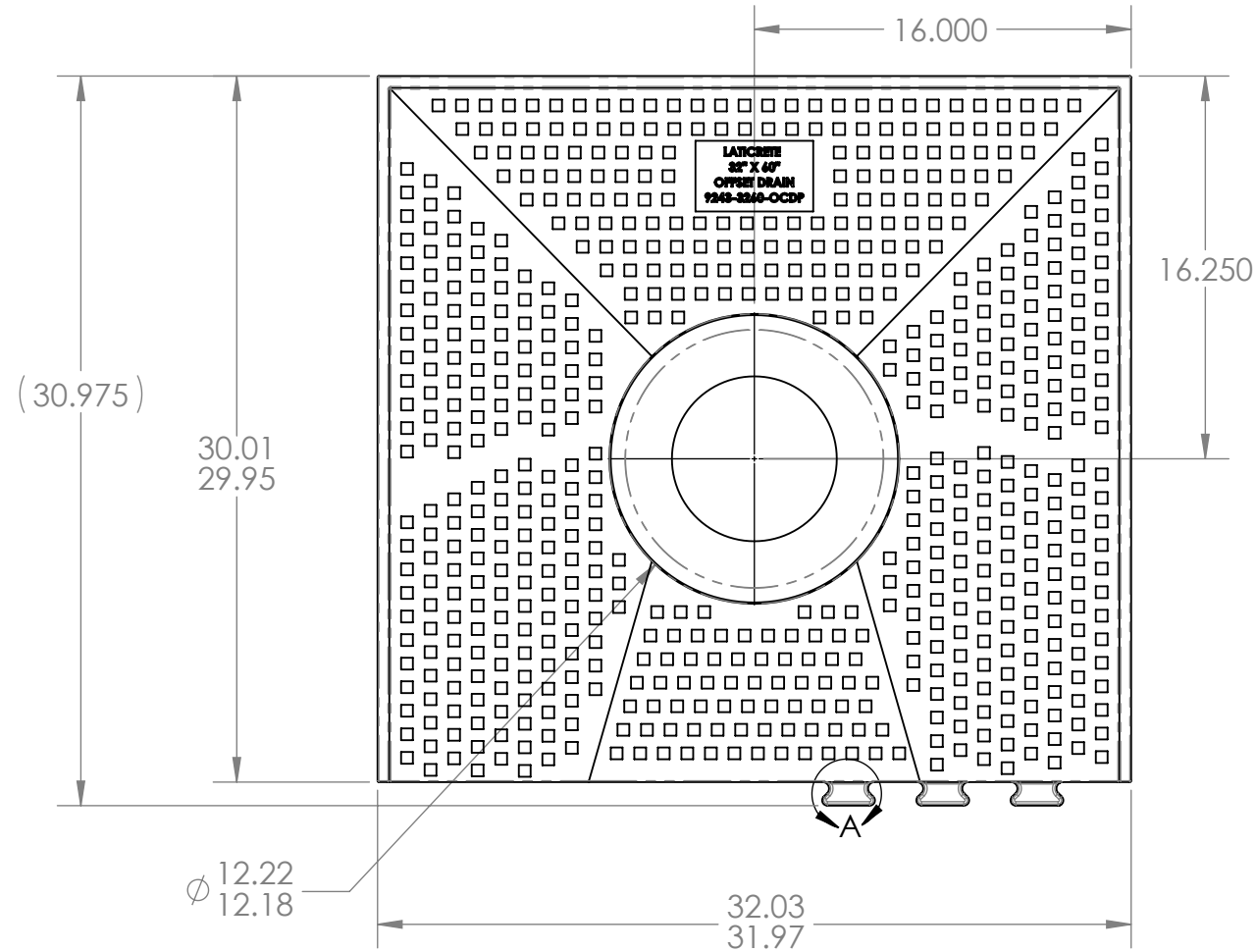

PROPRIETARY AND CONFIDENTIAL

THE INFORMATION CONTAINED IN THIS DRAWING IS THE SOLE PROPERTY OF LATICRETE INTERNATIONAL, INC. ANY REPRODUCTION IN PART OR AS A WHOLE WITHOUT THE WRITTEN PERMISSION OF LATICRETE INTERNATIONAL IS PROHIBITED.

LATICRETE INTERNATIONAL INC.
91 AMITY ROAD
BETHANY CT 06524

UNLESS OTHERWISE SPECIFIED:	NAME	DATE
DIMENSIONS ARE IN INCHES	BAYER	5/23/18
TOLERANCES:	DRAWN BY	
ANGULAR: MACH ± 2 BEND ± 5	CHECKED BY	
TWO PLACE DECIMAL ± .010	APPROVED BY	
THREE PLACE DECIMAL ± .005	COMMENTS:	
INTERPRET GEOMETRIC TOLERANCING PER: ASME Y14.5 - 2009		
MATERIAL		
SEE NOTES		
FINISH		
N/A		
DO NOT SCALE DRAWING		

LATICRETE		
TITLE: 32"X60" OFF CENTER DRAIN PAN HALF 2		
SIZE	DWG. NO.	REV
B	9243-3260-OCDF-002	D
SCALE: 1:8	WEIGHT:	SHEET 1 OF 1

4

3

2

1