

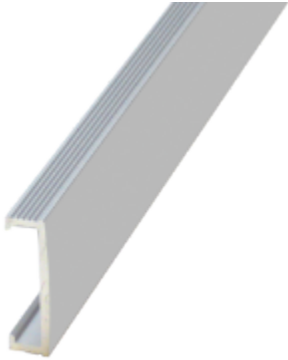

# Decorative Border Profiles - Style 1 (DB1)

DS-65387-0623

**Globally Proven  
Construction Solutions**



## Advantages

- Creates a 1" (25 mm) decorative design element
- Creates a clean, professional appearance
- Can be combined with other profiles such as Square Edge or Round Edge

## Suitable Substrates

- LATICRETE Profiles & Trims are compatible with LATICRETE Adhesive & Mortar products (Refer to the applicable adhesive and mortar data sheet for complete installation instructions and suitable substrates.)

## Limitations

- Areas subject to high chemical exposure such as swimming pools, commercial kitchens, etc. require the use of Stainless Steel 316.
- Normal wear and tear of profiles after installation is expected. As such, scratches, dents, corrosion, and/or discoloration resulting from typical use are not considered product defects.
- Stainless steel profiles are not impervious to all chemicals. Avoid contact with hydrochloric acid and hydrofluoric acid.
- Be careful of cross-contamination when cutting and avoid the use of unalloyed steel tools.

## Cautions

- Follow all tool manufacturer's directions, warning, and safety procedures when cutting and/or trimming profiles
- Cut edges may be sharp. Use caution when handling profiles.

## 4. TECHNICAL DATA

### Applicable Standard

Aluminum 6060 in accordance with DIN EN 755-1 (extruded Aluminum)

Surface anodized in accordance with DIN 17611

Stainless Steel 304 (V2A) Material number: 1.4301

Stainless Steel 316L (V4A) Material number: 1.4404

### Physical Properties

## 1. PRODUCT NAME

Decorative Border Profiles - Style 1 (DB1)

## 2. MANUFACTURER

LATICRETE International, Inc.

1 LATICRETE Park North

Bethany, CT 06524-3423 USA

Telephone: +1.203.393.0010, ext. 1235

Toll Free: 1.800.243.4788, ext. 1235

Fax: +1.203.393.1684

Website: [laticrete.com](http://laticrete.com)

## 3. PRODUCT DESCRIPTION

Decorative Border Profiles - Style 1 (DB1) can be used to create a 1" (25 mm) wide decorative design element within a field of tiles. They can be combined with other profiles such as Square Edge or Round Edge profiles to create unique and stunning designs. Available in Anodized Aluminum, Brass, and Stainless Steel, they are suitable for residential and commercial projects and can be used indoors and outdoors. Stainless steel profiles may also be used for floor applications.

### Uses

- Wall Applications
- Countertop Applications
- Floor Applications (Stainless Steel Only)

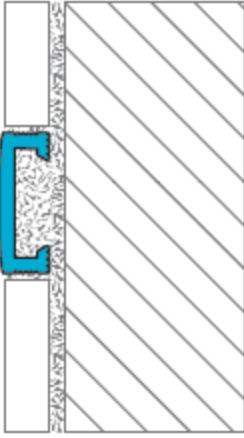

Property	Specification
Height	1/4" (6 mm)
Visible Width	1" (25 mm)
Length	8'-2.5" (2.5 m)
Nominal Thickness	1/16" (1.5 mm)
Hardness	250 HB
Melting point (approximate)	2624° F (1440° C)

#### Available Stainless Steel Finishes

- GLO - Gloss
- BRU - Brushed

#### Brass

Property	Specification
Height	1/4" (6 mm)
Width	1" (25 mm)
Length	8'-2.5" (2.5 m)
Nominal Thickness	1/16" (1.5 mm)
Melting point (approximate)	1643° F (895° C)

#### Available Finishes:

- CRP - Chrome Plated

#### Working Properties

#### Decorative Border Profiles - Typical Uses by Material & Finish

	Floors	Walls	Countertops
Anodized Aluminum		X	X
Stainless Steel 304	X	X	X
Stainless Steel 316	X	X	X
Brass		X	X

Specifications subject to change without notification. Results shown are typical but reflect test procedures used. Actual field performance will depend on installation methods and site conditions.

## 5. INSTALLATION

### Selecting the Correct Size Profile

#### Anodized Aluminum

Property	Specification
Height	1/4" (6 mm)
Visible Width	1" (25 mm)
Length	8'-2.5" (2.5 m)
Nominal Thickness	1/16" (1.5 mm)
Hardness	70 - 80 HB
Melting point (approximate)	1220° F (660° C)

#### Available Anodized Aluminum Finishes

- SAT - Satin
- PCR - Polished Chrome
- BCR - Brushed Chrome
- SNI - Satin Nickel
- PNI - Polished Nickel
- BNI - Brushed Nickel
- SCU - Satin Copper
- PCU - Polished Copper
- BCU - Brushed Copper
- SBR - Satin Brass
- PBR - Polished Brass
- BBR - Brushed Brass

#### Stainless Steel

Careful selection of the profile size is critical to ensuring the functionality and appearance of the final installation. Decorative Border Profiles - Style 1 may be used with tiles 1/4" (6 mm) or thicker.

### **Cutting Aluminum Profiles**

Always refer to the cutting tool manufacturer's instructions, cautions, and requirements prior to cutting profiles. Use appropriate safety equipment and personal protective equipment (PPE) as instructed by the manufacturer of the cutting tool.

Prior to installing the tile, make sure the profiles, corners, and connectors are accurately measured and dry-fitted. Measure and mark the profile to the correct length before cutting. Aluminum profiles may be cut with any of the following tools:

- A miter box and hacksaw with a bimetal blade and the highest teeth per inch (TPI)
- A variable speed angle grinder set to the lowest speed and equipped with a suitable non-ferrous cutting wheel.
- A chop saw or miter saw with a suitable non-ferrous blade.

Once cut, inspect the cut end and use a file to remove any burrs that may have formed during the cutting process. If necessary, the mounting leg may be trimmed using metal or tin snips to avoid interference or overlapping of adjacent profile pieces.

### **Cutting Stainless Steel Profiles**

Always refer to the cutting tool manufacturer's instructions, cautions, and requirements prior to cutting profiles. Use appropriate safety equipment and personal protective equipment (PPE) as instructed by the manufacturer of the cutting tool.

Prior to installing the tile, make sure the profiles, corners, and connectors are accurately measured and dry-fitted. Measure and mark the profile to the correct length before cutting. Stainless Steel profiles may be cut with any of the following tools:

- A variable speed angle grinder set to the lowest speed and equipped with a suitable non-ferrous cutting wheel.
- A band saw with a suitable non-ferrous blade.

Once cut, inspect the cut end and use a file to remove any burrs that may have formed during the cutting process. If necessary, the mounting leg may be trimmed using metal or tin snips to avoid interference or overlapping of adjacent profile pieces. Use tools dedicated to stainless steel cutting and take care to avoid cross-contamination.

### **Cutting Brass Profiles**

Always refer to the cutting tool manufacturer's instructions, cautions, and requirements prior to cutting

profiles. Use appropriate safety equipment and personal protective equipment (PPE) as instructed by the manufacturer of the cutting tool.

Prior to installing the tile, make sure the profiles, corners, and connectors are accurately measured and dry-fitted. Measure and mark the profile to the correct length before cutting. Brass profiles may be cut with any of the following tools:

- A miter box and hacksaw with a bimetal blade and the highest teeth per inch (TPI)
- A chop saw or miter saw with a suitable non-ferrous blade.

Once cut, inspect the cut end and use a file to remove any burrs that may have formed during the cutting process. If necessary, the mounting leg may be trimmed using metal or tin snips to avoid interference or overlapping of adjacent profile pieces.

### **Installing Profiles**

Apply tile adhesive with a margin or notched trowel to the area where the profile will be installed. Apply additional tile adhesive to the back of the decorative border profile filling the open space in the backside of the profile. Firmly press the profile into the adhesive, ensuring the profile and tile are aligned and flush. Leave a 1/16" to 1/8" gap between the profile and tile for grouting. For tiles thicker than 1/4" (6 mm) additional adhesive may be necessary to bring the profile flush with the tile. Adjust and straighten the profile if necessary. Continue tiling the rest of the area.

Immediately after installing the profiles and tile, clean the surface of the profile to remove any residual adhesive or cement material with clean fresh water and a sponge or microfiber cloth. Aluminum is sensitive to alkaline materials and failure to clean the profile surface can lead to staining or discoloration (oxidation spots) which can be very difficult to remove.

## **6. AVAILABILITY AND COST**

### **Availability**

LATICRETE materials are available worldwide.

### **For Distributor Information, Call:**

Toll Free: 1.800.243.4788

Telephone: +1.203.393.0010

For on-line distributor information, visit [LATICRETE at laticrete.com](http://laticrete.com)

### **Cost**

Contact a LATICRETE Distributor in your area.

## **7. WARRANTY**

See 10. FILING SYSTEM:

- 1 Year Product Warranty (US - English)
- 5 Year System Warranty (US - English)

- 10 Year System Warranty (US - English)
- 25 Year System Warranty (US - English)
- LATICRETE Lifetime System Warranty (US - English)

## 8. MAINTENANCE

Aluminum, Stainless Steel and Brass profiles require no special maintenance or care but should be periodically cleaned to maintain their appearance. Clean profiles using fresh clean water and a soft sponge or microfiber cloth, a neutral pH cleaner such as STONETECH® Stone & Tile Cleaner may also be used. If cleaning agents are used, they must be free of hydrochloric and/or hydrofluoric acids. Do not use any abrasive cleaning products as they can scratch or mar the decorative surface.

It is normal for Brass profiles with a natural finish to patina or oxidize over time. If necessary, brass profiles may be polished with special cleaning or polishing pastes designed specifically for use on brass.

## 9. TECHNICAL SERVICES

### Technical Assistance

Information is available by calling the LATICRETE Technical Service Hotline:

Toll Free: 1.800.243.4788, ext. 1235  
Telephone: +1.203.393.0010, ext. 1235  
Fax: +1.203.393.1948

### Technical and Safety Literature

To acquire technical and safety literature, please visit our website at [laticrete.com](http://laticrete.com).

## 10. FILING SYSTEM

Additional product information is available on our website at [laticrete.com](http://laticrete.com). The following is a list of related documents:

DS-6200.1: LATASIL™

---

LATICRETE International, Inc.

One LATICRETE Park North, Bethany, CT 06524-3423 USA • 1.800.243.4788 • +1.203.393.0010 • [www.laticrete.com](http://www.laticrete.com)

© 2024 LATICRETE International, Inc. All trademarks shown are the intellectual properties of their respective owners.