

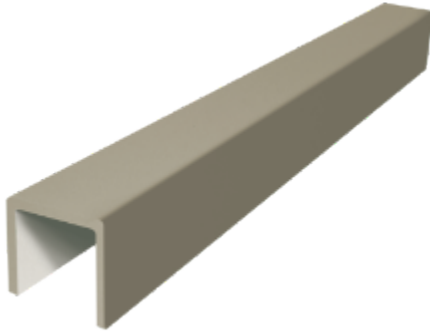

Bordure préformée superposée HYDRO BAN®

DS-65F-0524

**Globally Proven
Construction Solutions**



1. NOM DU PRODUIT

Bordure préformée superposée HYDRO BAN®

2. FABRICANT

LATICRETE International, Inc.

1 LATICRETE Park North

Bethany, CT 06524-3423 États-Unis

Téléphone: +1.203.393.0010, poste 1235

Numéro sans frais: 1.800.243.4788, poste 1235

Télécopieur: +1.203.393.1684

Site Web: laticrete.com

3. DESCRIPTION DU PRODUIT

HYDRO BAN Preformed Curb Overlay is made from high-density expanded polystyrene with a liquid waterproof membrane coating. HYDRO BAN Preformed Curb Overlay is lightweight and ready-to-til.

Utilisation

- Interior use only
- Industrial, commercial and residential bathrooms where an overlay curb is required
- Stalled gang showers
- Pet showers

Avantages

- The HYDRO BAN Preformed Curb Overlay is ready to tile and eliminates the need for traditional mud curbs
- Lightweight and durable. Easy to transport and handle during installation
- Factory installed, code approved waterproofing meets ANSI A118.10 requirements
- Can quickly and easily be modified to size on site

- Works in conjunction with most tile and stone installation materials

Supports Appropriés

Conditionnement

Bordures superposées d'une longueur de 122 cm (4 pi), emballée une par carton, bordure superposée d'une longueur de 244 cm (8 pi), emballée une par carton

Restrictions

- Adhesives/mastics, mortars and grouts for ceramic tile, pavers, brick and stone are not replacements for waterproofing membranes. When a waterproofing membrane is required, use HYDRO BAN.
- Do not expose unprotected HYDRO BAN Preformed Curb Overlay to sun or weather for more than 30 days.
- Do not expose to rubber solvents or ketones.
- Must be covered with ceramic tile, stone, finish. Use protection board for temporary cover prior to finishing.
- Note: Surfaces must be structurally sound, stable and rigid enough to support ceramic/stone tile, thin brick and similar finishes. Substrate deflection under all live, dead and impact loads, including concentrated loads, must not exceed L/360 for thin bed ceramic tile/brick installations or L/480 for thin bed stone installations and L/600 for all exterior veneer applications where L=span length.

Mises en garde

- Consult SDS for more safety information.
- During cold weather, protect finished work from traffic until fully cured.
- For white and light-colored marbles, use a white latex portland cement thin-set mortar.
- For green and moisture sensitive marble, agglomerates and resin backed tile and stone use LATAPOXY® 300 Adhesive (refer to DS 633.0).
- If the waterproof coating on the HYDRO BAN® Preformed Curb Overlay is punctured during installation or from job site construction activity re-coat the punctured area and 2" (50 mm) around the area with two coats of HYDRO BAN, follow DS 663.0 or DS 663.5 for full instructions.

4. DONNÉES TECHNIQUES

Caractéristiques sous réserve de modification sans préavis. Les résultats présentés sont typiques, mais ils

reflètent les procédures d'essai utilisées. Les performances réelles sur le terrain dépendent des méthodes de pose et des conditions locales.

5. POSE

• Preparatory Work

- Ensure that walls are square and plumb for proper fit of curb overlay.
- Structure under curb overlay must be clean and level. Make sure nails are counter sunk and do not protrude into curb overlay.
- Test fit curb overlay to make certain it fits over 2" x 4" (50 x 100 mm) structure properly and sits flush and level with floor.
- If the curb overlay needs to be site adjusted to fit the shower and 2" x 4" (50 x 100 mm) structure use a circular saw or utility knife to cut the curb overlay to the proper shower dimensions.
- Dry fit the curb overlay to make certain it properly fits over the 2" x 4" (50 x 100 mm) structure and sits flush and level with the floor.

Installation (See Detail ES-WP 312)

- Note: in traditional mud bed shower installations the HYDRO BAN Preformed Curb Overlay should be installed before installation of mortar bed and after installation of primary pan liner. In shower installations using a topically applied waterproofing membrane which eliminates the pre-slope and primary shower pan liner the HYDRO BAN Preformed Curb Overlay should be installed prior to the mortar bed.
- Coat inside of HYDRO BAN Preformed Curb Overlay with a polymer fortified thin-set mortar and place over pan liner or 2" x 4" (50 x 100 mm) construction.
- Ensure that HYDRO BAN Preformed Curb Overlay is set firmly against curb structure.
- After leveling HYDRO BAN Preformed Curb Overlay, secure with large headed fastener on outside of curb structure. Do not compromise inside of curb structure with fasteners.
- Apply two coats of HYDRO BAN (follow instructions in HYDRO BAN DS 663.0 and 663.5) where HYDRO BAN Preformed Curb Overlay meets the wall/jamb and shower pan interface.

6. DISPONIBILITÉ ET COÛT

Disponibilité

Les produits LATICRETE® et LATAPOXY® sont proposés dans le monde entier.

Appeler un des numéros suivants pour obtenir des informations relatives aux distributeurs:

Numéro sans frais: 1.800.243.4788

Téléphone: +1.203.393.0010

Pour obtenir de l'information en ligne de distributeurs, visiter LATICRETE à l'adresse suivante laticrete.com

Coût

Communiquez avec le distributeur LATICRETE le plus proche.

7. GARANTIE

Voir 10. SYSTÈME DE CLASSIFICATION:

- 25 Year System Warranty (US) (English)
- 10 Year System Warranty (US) (English)
- 1 Year Product Warranty (US) (English)
- LATICRETE Lifetime System Warranty (US) (English)

8. ENTRETIEN

LATICRETE and LATAPOXY grouts require routine cleaning with a neutral pH soap and water. All other LATICRETE and LATAPOXY materials require no maintenance but installation performance and durability may depend on properly maintaining products supplied by other manufacturers. 9. TECHNICAL SERVICES Technical Assistance Information is available by calling the LATICRETE Technical Service Hotline: Toll Free: 1.800.243.4788 ext. 235 Telephone: +1.203.393.0010 ext. 235 Fax: +1.203.393.1948

9. SERVICES TECHNIQUES

Soutien technique

Pour tout renseignement, appeler la ligne d'aide du service technique de LATICRETE:

Numéro sans frais: 1.800.243.4788, ext. 1235

Téléphone: +1.203.393.0010, ext. 1235

Télécopieur: +1.203.393.1948

Documentation technique et de sécurité

Pour obtenir la documentation technique et les consignes de sécurité, visiter notre site Web à laticrete.com.

10. SYSTÈME DE CLASSIFICATION

Des informations supplémentaires sur les produits sont disponibles sur notre site Web à laticrete.com. Liste des documents connexes:

- DS 230.13: LATICRETE Product Warranty (United States and Canada)
- DS 025.0APD: LATICRETE 25 Year Tile & Stone System Warranty (United States and Canada)
- DS 230.99: LATICRETE Lifetime Tile & Stone System Warranty (United States and Canada)
- DS 031.0: HYDRO BAN Pre-Sloped Shower Pan
- DS 663.0: HYDRO BAN

LATICRETE International, Inc.

One LATICRETE Park North, Bethany, CT 06524-3423 USA • 1.800.243.4788 • +1.203.393.0010 • www.laticrete.com

© 2024 LATICRETE International, Inc. All trademarks shown are the intellectual properties of their respective owners.

- DS 633.0: LATAPOXY 300 Adhesive