

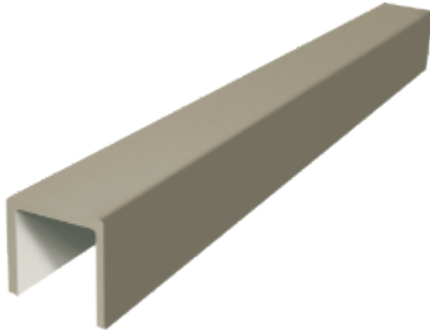

HYDRO BAN® Borde Preformado con Recubrimiento Protector

DS-65E-0524

**Globally Proven
Construction Solutions**



1. NOMBRE DEL PRODUCTO

HYDRO BAN® Borde Preformado con Recubrimiento Protector

2. FABRICANTE

LATICRETE International, Inc.
1 LATICRETE Park North
Bethany, CT 06524-3423 USA

Teléfono: +1.203.393.0010, ext. 1235
Línea telefónica gratuita: 1.800.243.4788, ext. 1235

Fax: +1.203.393.1684
Sitio de Internet: laticrete.com

3. DESCRIPCIÓN DEL PRODUCTO

HYDRO BAN Preformed Curb Overlay is made from high-density expanded polystyrene with a liquid waterproof membrane coating. HYDRO BAN Preformed Curb Overlay is lightweight and ready-to-tile.

Usos

- Interior use only
- Industrial, commercial and residential bathrooms where an overlay curb is required
- Stalled gang showers
- Pet showers

Ventajas

- The HYDRO BAN Preformed Curb Overlay is ready to tile and eliminates the need for traditional mud curbs
- Lightweight and durable. Easy to transport and handle during installation
- Factory installed, code approved waterproofing meets ANSI A118.10 requirements

- Can quickly and easily be modified to size on site
- Works in conjunction with most tile and stone installation materials

Sustratos adecuados

Presentación

Borde con recubrimiento protector de 122 cm (4 pulg.) de largo; 1 unidad por caja, borde con recubrimiento protector de 244 cm (8 pulg.) de largo; 1 unidad por caja

Limitaciones

- Adhesives/mastics, mortars and grouts for ceramic tile, pavers, brick and stone are not replacements for waterproofing membranes. When a waterproofing membrane is required, use HYDRO BAN.
- Do not expose unprotected HYDRO BAN Preformed Curb Overlay to sun or weather for more than 30 days.
- Do not expose to rubber solvents or ketones.
- Must be covered with ceramic tile, stone, finish. Use protection board for temporary cover prior to finishing.
- Note: Surfaces must be structurally sound, stable and rigid enough to support ceramic/stone tile, thin brick and similar finishes. Substrate deflection under all live, dead and impact loads, including concentrated loads, must not exceed L/360 for thin bed ceramic tile/brick installations or L/480 for thin bed stone installations and L/600 for all exterior veneer applications where L=span length.

Precauciones

- Consult SDS for more safety information.
- During cold weather, protect finished work from traffic until fully cured.
- For white and light-colored marbles, use a white latex portland cement thin-set mortar.
- For green and moisture sensitive marble, agglomerates and resin backed tile and stone use LATAPOXY® 300 Adhesive (refer to DS 633.0).
- If the waterproof coating on the HYDRO BAN® Preformed Curb Overlay is punctured during installation or from job site construction activity re-coat the punctured area and 2" (50 mm) around the area with two coats of HYDRO BAN, follow DS 663.0 or DS 663.5 for full instructions.

4. DATOS TÉCNICOS

Las especificaciones están sujetas a cambios sin notificación. Los resultados exhibidos son representativos pero reflejan los procedimientos de prueba utilizados. El desempeño real en el área de trabajo dependerá de los métodos de instalación y de las condiciones del lugar.

5. INSTALACIÓN

• Preparatory Work

- Ensure that walls are square and plumb for proper fit of curb overlay.
- Structure under curb overlay must be clean and level. Make sure nails are counter sunk and do not protrude into curb overlay.
- Test fit curb overlay to make certain it fits over 2" x 4" (50 x 100 mm) structure properly and sits flush and level with floor.
- If the curb overlay needs to be site adjusted to fit the shower and 2" x 4" (50 x 100 mm) structure use a circular saw or utility knife to cut the curb overlay to the proper shower dimensions.
- Dry fit the curb overlay to make certain it properly fits over the 2" x 4" (50 x 100 mm) structure and sits flush and level with the floor.

Installation (See Detail ES-WP 312)

- Note: in traditional mud bed shower installations the HYDRO BAN Preformed Curb Overlay should be installed before installation of mortar bed and after installation of primary pan liner. In shower installations using a topically applied waterproofing membrane which eliminates the pre-slope and primary shower pan liner the HYDRO BAN Preformed Curb Overlay should be installed prior to the mortar bed.
- Coat inside of HYDRO BAN Preformed Curb Overlay with a polymer fortified thin-set mortar and place over pan liner or 2" x 4" (50 x 100 mm) construction.
- Ensure that HYDRO BAN Preformed Curb Overlay is set firmly against curb structure.
- After leveling HYDRO BAN Preformed Curb Overlay, secure with large headed fastener on outside of curb structure. Do not compromise inside of curb structure with fasteners.
- Apply two coats of HYDRO BAN (follow instructions in HYDRO BAN DS 663.0 and 663.5) where HYDRO BAN Preformed Curb Overlay meets the wall/jamb and shower pan interface.

6. DISPONIBILIDAD Y COSTO

Disponibilidad

Los materiales LATICRETE® y LATAPOXY® están disponibles en todo el mundo.

Para obtener información sobre los distribuidores, llame a:

Línea telefónica gratuita: 1.800.243.4788

Teléfono: +1.203.393.0010

Para obtener información sobre los distribuidores en Internet, visite LATICRETE en laticrete.com

Costo

Comuníquese con un distribuidor de LATICRETE de su zona.

7. GARANTÍA

Consulte la Sección 10. SISTEMAS ESPECIALES:

- 25 Year System Warranty (US) (English)
- 10 Year System Warranty (US) (English)
- 1 Year Product Warranty (US) (English)
- LATICRETE Lifetime System Warranty (US) (English)

8. MANTENIMIENTO

LATICRETE and LATAPOXY grouts require routine cleaning with a neutral pH soap and water. All other LATICRETE and LATAPOXY materials require no maintenance but installation performance and durability may depend on properly maintaining products supplied by other manufacturers. 9. TECHNICAL SERVICES Technical Assistance Information is available by calling the LATICRETE Technical Service Hotline: Toll Free: 1.800.243.4788 ext. 235 Telephone: +1.203.393.0010 ext. 235 Fax: +1.203.393.1948

9. DEPARTAMENTO DE ASISTENCIA TÉCNICA

Asistencia técnica

Para obtener más información, comuníquese con la Línea Directa del Departamento de Asistencia Técnica de LATICRETE:

Línea telefónica gratuita:

1.800.243.4788, ext. 1235

Teléfono: +1.203.393.0010, ext. 1235

Fax: +1.203.393.1948

Material informativo sobre aspectos técnicos y de seguridad

Para obtener material sobre aspectos técnicos y de seguridad, visite nuestro sitio web en laticrete.com.

10. SISTEMAS ESPECIALES

Podrá obtener más información sobre los productos en nuestro sitio web laticrete.com. A continuación, encontrará una lista de documentos afines:

- DS 230.13: LATICRETE Product Warranty (United States and Canada)
- DS 025.0APD: LATICRETE 25 Year Tile & Stone System Warranty (United States and Canada)
- DS 230.99: LATICRETE Lifetime Tile & Stone System Warranty (United States and Canada)
- DS 031.0: HYDRO BAN Pre-Sloped Shower Pan
- DS 663.0: HYDRO BAN

- DS 633.0: LATAPOXY 300 Adhesive

LATICRETE International, Inc.
One LATICRETE Park North, Bethany, CT 06524-3423 USA • 1.800.243.4788 • +1.203.393.0010 • www.laticrete.com
© 2024 LATICRETE International, Inc. All trademarks shown are the intellectual properties of their respective owners.