

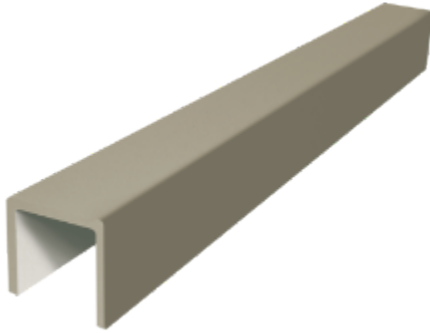

HYDRO BAN[®] Preformed Curb Overlay

DS-65-0524

**Globally Proven
Construction Solutions**



- Works in conjunction with most tile and stone installation materials

Suitable Substrates

- Exterior Glue Plywood (Interior Only)
- Cement Backer Board
- Oriented Strand Board (OSB)
- Oriented Strand Board (OSB)

Packaging

4' (122 cm) long curb overlay; Packaged one per carton
8' (244 cm) long curb overlay; Packaged one per carton

1. PRODUCT NAME

HYDRO BAN[®] Preformed Curb Overlay

2. MANUFACTURER

LATICRETE International, Inc.
1 LATICRETE Park North
Bethany, CT 06524-3423 USA

Telephone: +1.203.393.0010, ext. 1235
Toll Free: 1.800.243.4788, ext. 1235
Fax: +1.203.393.1684
Website: laticrete.com

3. PRODUCT DESCRIPTION

HYDRO BAN Preformed Curb Overlay is made from high-density expanded polystyrene with a liquid waterproof membrane coating. HYDRO BAN Preformed Curb Overlay is lightweight and ready-to-tile.

Uses

- Interior use only
- Industrial, commercial and residential bathrooms where an overlay curb is required
- Stalled gang showers
- Pet showers

Advantages

- The HYDRO BAN Preformed Curb Overlay is ready to tile and eliminates the need for traditional mud curbs
- Lightweight and durable. Easy to transport and handle during installation
- Factory installed, code approved waterproofing meets ANSI A118.10 requirements
- Can quickly and easily be modified to size on site

Limitations

- Adhesives/mastics, mortars and grouts for ceramic tile, pavers, brick and stone are not replacements for waterproofing membranes. When a waterproofing membrane is required, use HYDRO BAN.
- Do not expose unprotected HYDRO BAN Preformed Curb Overlay to sun or weather for more than 30 days.
- Do not expose to rubber solvents or ketones.
- Must be covered with ceramic tile, stone, finish. Use protection board for temporary cover prior to finishing.
- Note: Surfaces must be structurally sound, stable and rigid enough to support ceramic/stone tile, thin brick and similar finishes. Substrate deflection under all live, dead and impact loads, including concentrated loads, must not exceed L/360 for thin bed ceramic tile/brick installations or L/480 for thin bed stone installations and L/600 for all exterior veneer applications where L=span length.

Cautions

- Consult SDS for more safety information.
- During cold weather, protect finished work from traffic until fully cured.
- For white and light-colored marbles, use a white latex portland cement thin-set mortar.
- For green and moisture sensitive marble, agglomerates and resin backed tile and stone use LATAPOXY[®] 300 Adhesive (refer to DS 633.0).
- If the waterproof coating on the HYDRO BAN[®] Preformed Curb Overlay is punctured during

installation or from job site construction activity re-coat the punctured area and 2"

- (50 mm) around the area with two coats of HYDRO BAN, follow DS 663.0 or DS 663.5 for full instructions.

4. TECHNICAL DATA

Applicable Standard

- Waterproofing membrane meets ANSI A 118.10.

Specifications subject to change without notification. Results shown are typical but reflect test procedures used. Actual field performance will depend on installation methods and site conditions.

5. INSTALLATION

Preparatory Work

- Ensure that walls are square and plumb for proper fit of curb overlay.
- Structure under curb overlay must be clean and level. Make sure nails are counter sunk and do not protrude into curb overlay.
- Test fit curb overlay to make certain it fits over 2" x 4" (50 x 100 mm) structure properly and sits flush and level with floor.
- If the curb overlay needs to be site adjusted to fit the shower and 2" x 4" (50 x 100 mm) structure use a circular saw or utility knife to cut the curb overlay to the proper shower dimensions.
- Dry fit the curb overlay to make certain it properly fits over the 2" x 4" (50 x 100 mm) structure and sits flush and level with the floor.

Installation (See Detail ES-WP 312)

- Note: in traditional mud bed shower installations the HYDRO BAN Preformed Curb Overlay should be installed before installation of mortar bed and after installation of primary pan liner. In shower installations using a topically applied waterproofing membrane which eliminates the pre-slope and primary shower pan liner the HYDRO BAN Preformed Curb Overlay should be installed prior to the mortar bed.
- Coat inside of HYDRO BAN Preformed Curb Overlay with a polymer fortified thin-set mortar and place over pan liner or 2" x 4" (50 x 100 mm) construction.
- Ensure that HYDRO BAN Preformed Curb Overlay is set firmly against curb structure.
- After leveling HYDRO BAN Preformed Curb Overlay, secure with large headed fastener on outside of curb structure. Do not compromise inside of curb structure with fasteners.
- Apply two coats of HYDRO BAN (follow instructions in HYDRO BAN DS 663.0 and 663.5) where HYDRO BAN Preformed Curb Overlay meets the wall/jamb and shower pan interface.

6. AVAILABILITY AND COST

Availability

LATICRETE materials are available worldwide.

For Distributor Information, Call:

Toll Free: 1.800.243.4788

Telephone: +1.203.393.0010

For on-line distributor information, visit LATICRETE at laticrete.com

Cost

Contact a LATICRETE Distributor in your area.

7. WARRANTY

See 10. FILING SYSTEM:

- 25 Year System Warranty (US) (English)
- 10 Year System Warranty (US) (English)
- 1 Year Product Warranty (US) (English)
- LATICRETE Lifetime System Warranty (US) (English)

8. MAINTENANCE

LATICRETE and LATAPOXY grouts require routine cleaning with a neutral pH soap and water. All other LATICRETE and LATAPOXY materials require no maintenance but installation performance and durability may depend on properly maintaining products supplied by other manufacturers. 9. TECHNICAL SERVICES Technical Assistance Information is available by calling the LATICRETE Technical Service Hotline: Toll Free: 1.800.243.4788 ext. 235 Telephone: +1.203.393.0010 ext. 235 Fax: +1.203.393.1948

9. TECHNICAL SERVICES

Technical Assistance

Information is available by calling the LATICRETE Technical Service Hotline:

Toll Free: 1.800.243.4788, ext. 1235

Telephone: +1.203.393.0010, ext. 1235

Fax: +1.203.393.1948

Technical and Safety Literature

To acquire technical and safety literature, please visit our website at laticrete.com.

10. FILING SYSTEM

Additional product information is available on our website at laticrete.com. The following is a list of related documents:

- DS 230.13: LATICRETE Product Warranty (United States and Canada)
- DS 025.0APD: LATICRETE 25 Year Tile & Stone System Warranty (United States and Canada)

LATICRETE International, Inc.

One LATICRETE Park North, Bethany, CT 06524-3423 USA • 1.800.243.4788 • +1.203.393.0010 • www.laticrete.com

© 2024 LATICRETE International, Inc. All trademarks shown are the intellectual properties of their respective owners.

- DS 230.99: LATICRETE Lifetime Tile & Stone System Warranty (United States and Canada)
- DS 031.0: HYDRO BAN Pre-Sloped Shower Pan
- DS 663.0: HYDRO BAN
- DS 633.0: LATAPOXY 300 Adhesive