

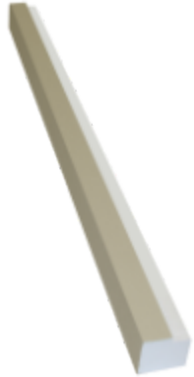

HYDRO BAN® Preformed Curb

DS-64-0924

**Globally Proven
Construction Solutions**



1. PRODUCT NAME

HYDRO BAN® Preformed Curb

2. MANUFACTURER

LATICRETE International, Inc.

1 LATICRETE Park North

Bethany, CT 06524-3423 USA

Telephone: +1.203.393.0010, ext. 1235

Toll Free: 1.800.243.4788, ext. 1235

Fax: +1.203.393.1684

Website: laticrete.com

3. PRODUCT DESCRIPTION

HYDRO BAN Preformed Curb is made from high-density expanded polystyrene with a liquid waterproof membrane coating applied to it. HYDRO BAN Preformed Curb is lightweight and ready-to-tile. Materials: Utility knife or fine tooth saw, latex fortified large, heavy tile mortar (eg. 4-XLT), 1/2" x 1/2" (12 x 12 mm) square notch trowel and HYDRO BAN Adhesive & Sealant.

Uses

- Interior use only
- Industrial
- Commercial and residential bathrooms or wet areas where a preformed curb is required
- Stalled gang showers
- Pet showers

Advantages

- Ready to tile preformed curb eliminates need for traditional curb installations

- Lightweight and durable. Easy to transport and handle during installation
- Factory installed, code approved waterproofing meets ANSI A118.10 requirements
- Can quickly and easily be modified to size on site
- Works in conjunction with tile and stone installation materials

Suitable Substrates

- Concrete
- Masonry Surfaces
- Tile or Stone
- Exterior Glue Plywood (Interior Only)
- Cement Backer Board
- Oriented Strand Board (OSB)
- Oriented Strand Board (OSB)

Packaging

5' (152 cm) long, 3 3/4" (10 cm) high, 3.5" (9 cm) wide. Packaged one to a carton.

Limitations

- Adhesives/mastics, mortars and grouts for ceramic tile, pavers, brick and stone are not replacements for waterproofing membranes. When a waterproofing membrane is required, use HYDRO BAN.
- Do not expose unprotected HYDRO BAN Preformed Curb to sun or weather for more than 30 days.
- Do not expose to rubber solvents or ketones.
- Must be covered with ceramic tile, stone, finish. Use protection board for temporary cover prior to finishing.
- Note: Surfaces must be structurally sound, stable and rigid enough to support ceramic/stone tile, thin brick and similar finishes. Substrate deflection under all live, dead and impact loads, including concentrated loads, must not exceed L/360 for thin bed ceramic tile/brick installations or L/480 for thin bed stone installations and L/600 for all exterior veneer applications where L=span length.

Cautions

- During cold weather, protect finished work from traffic until fully cured.

- For white and light-colored marbles, use a white latex portland cement thin set mortar.
- For green and moisture sensitive marble, agglomerates and resin backed tile and stone use LATAPOXY® 300 Adhesive (refer to DS 633.0).
- If the waterproof coating on the HYDRO BAN Preformed Curb is punctured during installation or from job site construction activity re-coat the punctured area and 2" (50 mm) around the area with two coats of HYDRO BAN, follow DS 663.0 or DS 663.5 for full instructions.
- A wooden 2"x4" (51 x 102 mm) curb structure with HYDRO BAN Curb Overlay is required when installing hingeless glass doors as with European-style glass enclosures with pins.

4. TECHNICAL DATA

Applicable Standard

- Waterproofing membrane meets ANSI A 118.10

Specifications subject to change without notification. Results shown are typical but reflect test procedures used. Actual field performance will depend on installation methods and site conditions.

5. INSTALLATION

- **Materials:** Utility knife or fine tooth saw, latex fortified medium bed mortar (eg. 4-XLT), 1/2" x 1/2" (12 x 12 mm) square notch trowel and HYDRO BAN Adhesive & Sealant.

Preparatory Work

- Ensure that walls are square and plumb for proper fit of pan.
- Subfloor under pan must be clean and level.
- Dry fit curb to make certain it fits the area for installation and sits flush and level with floor.
- Remove the curb.
- If the curb needs to be site adjusted to fit the installation area use a circular saw or utility knife to cut the curb to the proper dimensions.

Installation (See Detail ES-WP 305)

- Apply latex modified medium bed mortar to floor area and wall connecting to the end of the preformed curb.
- Apply skim coat of polymer fortified medium bed mortar (e.g. 4-XLT) to bottom and both ends of HYDRO BAN® Preformed Curb.
- Embed HYDRO BAN Preformed Curb into polymer fortified medium bed and apply weight to curb to properly seat curb into wet polymer fortified medium bed.
- Allow mortar to cure according to instructions.
- Apply 2 coats of HYDRO BAN where curb meets wall/jamb.
- Install HYDRO BAN Pre-Sloped Shower Pan per instructions and TCNA guidelines.

- Extend HYDRO BAN using 2 coats from pan up and over HYDRO BAN Preformed Curb.
- Install tile according to LATICRETE® installation instructions and industry guidelines

6. AVAILABILITY AND COST

Availability

LATICRETE materials are available worldwide.

For Distributor Information, Call:

Toll Free: 1.800.243.4788

Telephone: +1.203.393.0010

For on-line distributor information, visit LATICRETE at

laticrete.com

Cost

Contact a LATICRETE Distributor in your area.

7. WARRANTY

See 10. FILING SYSTEM:

- 25 Year System Warranty (US) (English)
- 10 Year System Warranty (US) (English)
- 1 Year Product Warranty (US) (English)
- LATICRETE Lifetime System Warranty (US) (English)

8. MAINTENANCE

LATICRETE and LATAPOXY grouts require routine cleaning with a neutral pH soap and water. All other LATICRETE and LATAPOXY materials require no maintenance but installation performance and durability may depend on properly maintaining products supplied by other manufacturers.

9. TECHNICAL SERVICES

Technical Assistance

Information is available by calling the LATICRETE Technical Service Hotline:

Toll Free: 1.800.243.4788, ext. 1235

Telephone: +1.203.393.0010, ext. 1235

Fax: +1.203.393.1948

Technical and Safety Literature

To acquire technical and safety literature, please visit our website at laticrete.com.

10. FILING SYSTEM

Additional product information is available on our website at laticrete.com. The following is a list of related documents:

- DS 230.13: LATICRETE Product Warranty
- DS 230.10: LATICRETE 10 Year System Warranty (United States and Canada)
- DS 025.0: LATICRETE 25 Year System Warranty (United States and Canada)
- DS 230.99: LATICRETE Lifetime Warranty (United States and Canada)
- DS 108.0: HYDRO BAN Adhesive & Sealant
- DS 663.0: HYDRO BAN

- DS 031.0: HYDRO BAN Pre-Sloped Shower Pan
- DS 080.0: 4-XLT
- DS 633.0: LATAPOXY 300 Adhesive